



# Rolls-Royce



Project : Rolls-Royce  
Location : Glasgow, United Kingdom  
Product : HunterDouglas® Façades: type Sandwich Wall  
Quantity : 800 m<sup>2</sup>  
Special : Curved panels  
Architect : Bradford Robertson Architects

## HunterDouglas

FAÇADES

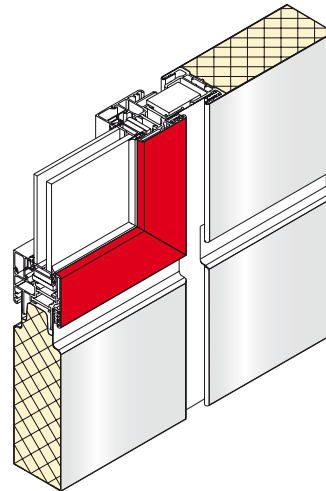

### SYSTEM OVERVIEW SANDWICH WALL

#### SANDWICH WALL

- Made to measure panels
- Up to 12 meters in length
- Standard widths but any panel module up to 1500 mm wide is available
- Choice of skin materials: aluminium, stainless steel and steel
- Superior flatness
- Texture and formed skin shapes
- 'Total' façade system including fully integrated windows and doors
- Dry sealed system
- Bi-modular joints, identical joint design at all four panel sides
- Foam or mineral wool core
- Certified fire performance (LPCB/FM/CWCT)
- Horizontal and vertical installations
- Unique, concealed mounting system
- For new build and over-cladding projects

#### Mester Udvarhaz, office building

Theme: Thermal, acoustical en fire performance

The prestigious new state-of-the-art Rolls Royce aerospace engine facility near Glasgow has been completed to incorporate an architecturally striking façade using the HunterDouglas Bi-Modular Sandwich Wall Façade system.

Given the final manufacturing use of the building, Rolls Royce required very strict standards with regard to how the façade performs thermally, acoustically and in a fire situation. Hunter Douglas Construction Elements assisted the project architect in designing a suitable façade which exceeded their requirements in all these areas.